

PRODUCT/MODEL: SERVICE AGL FOR GRETA 2 CHAIR WITH & W/O HEADREST

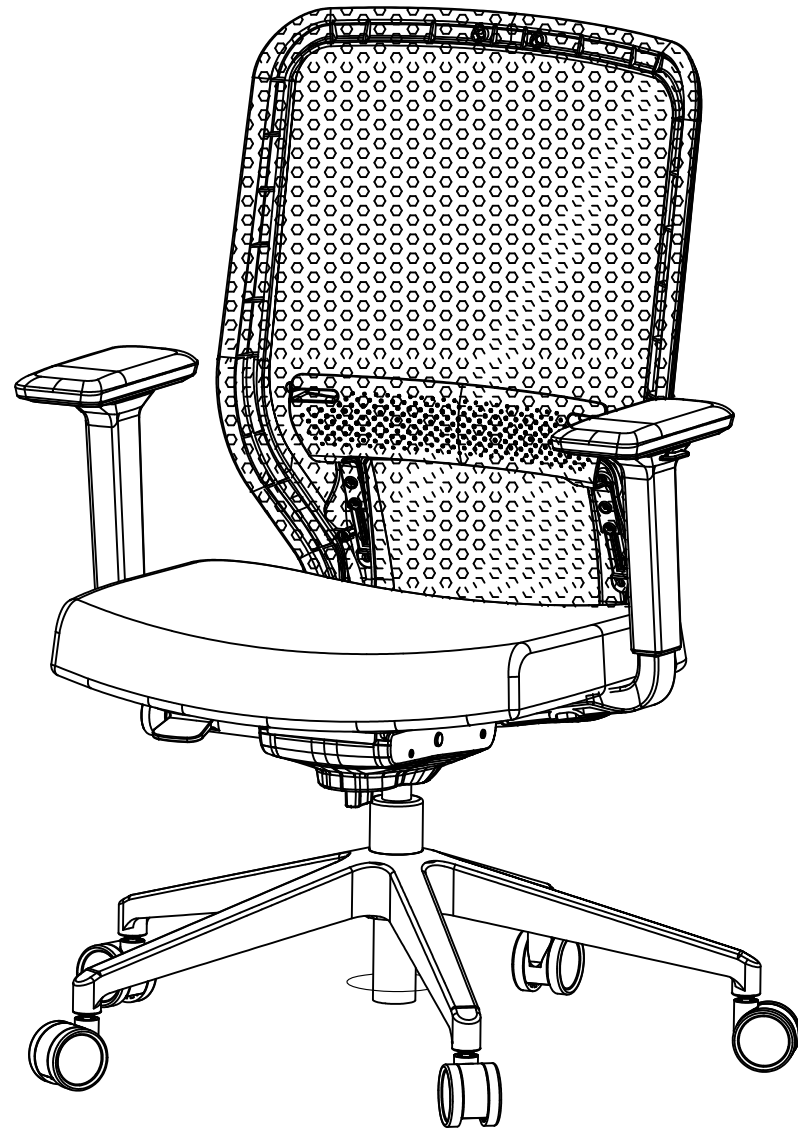

GRETA 2 CHAIR

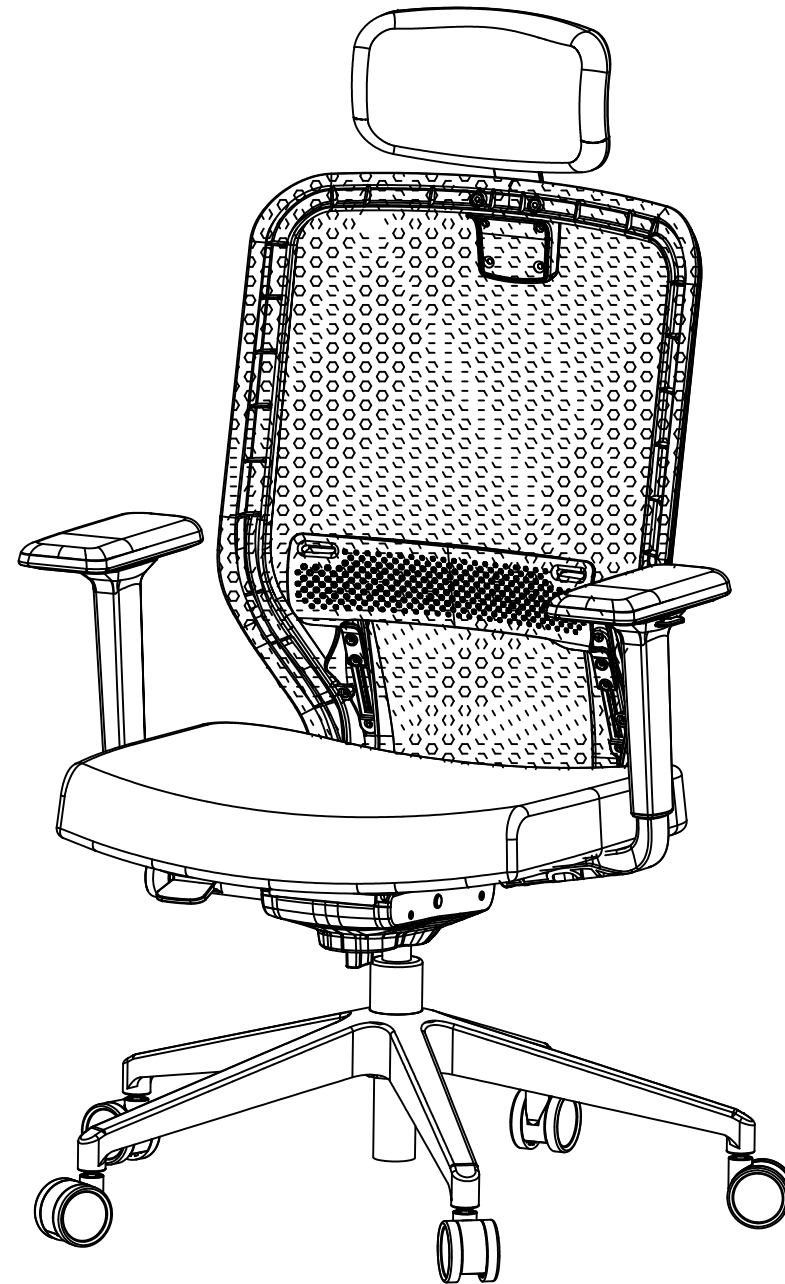

GRETA 2 CHAIR WITH HEADREST

REV	MODIFICATION	MOD. BY	DATE	CH.NOTE NO

This Document is the copyrighted works of Godrej & Boyce Mfg. Co. Ltd. Godrej & Boyce Mfg. Co. Ltd. reserves all rights whatsoever in the document. Godrej & Boyce Mfg. Co. Ltd. asserts its rights over this document that has been conceived by the dint of its efforts and also views reproduction of this document, as it is or by making cosmetic or other changes, as a violation of its copyright. No part of this document shall be copied or reproduced without the written approval of Godrej & Boyce Mfg. Co. Ltd.

PRODUCT/MODEL: SERVICE AGL FOR GRETA 2 CHAIR WITH & W/O HEADREST

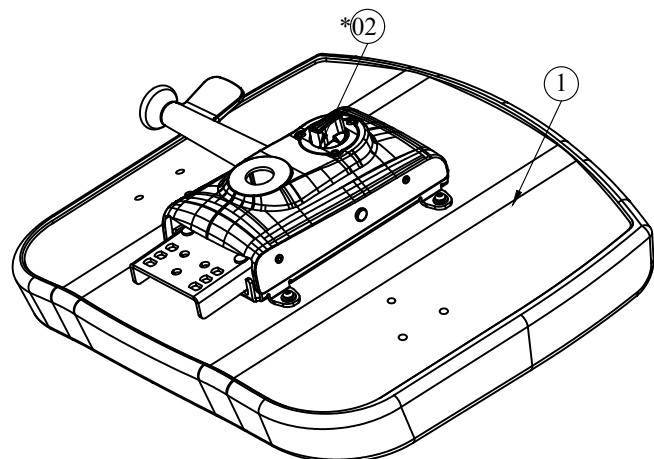

STEP-1:
TAKE THE SEAT WITH THE ASSEMBLED MECHANISM.

NOTE:
#-TO BE ASSEMBLED USING A TORQUE WRENCH WITH TIGHTENING TORQUE NOT LESS THAN 9.0 N-m.

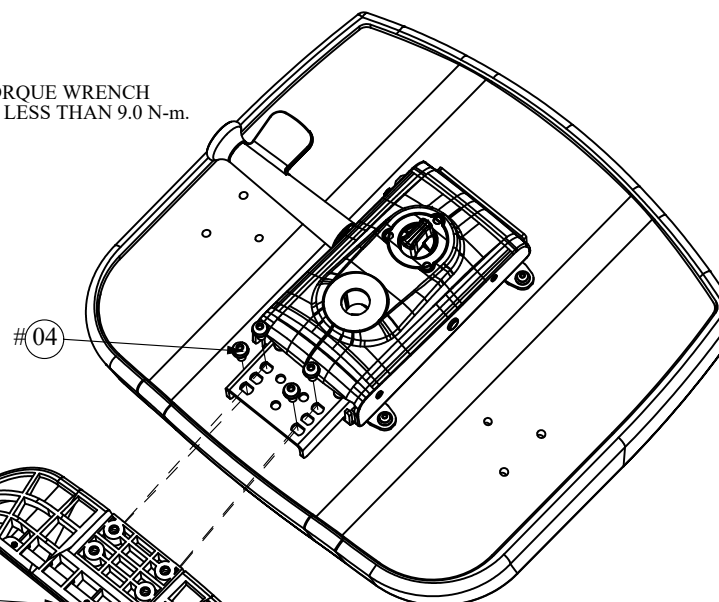

STEP-2:
SCREW THE BACK TO THE MECHANISM.
(NOTE : MAINTAIN UNIFORM GAP BETWEEN SEAT AND BACK)

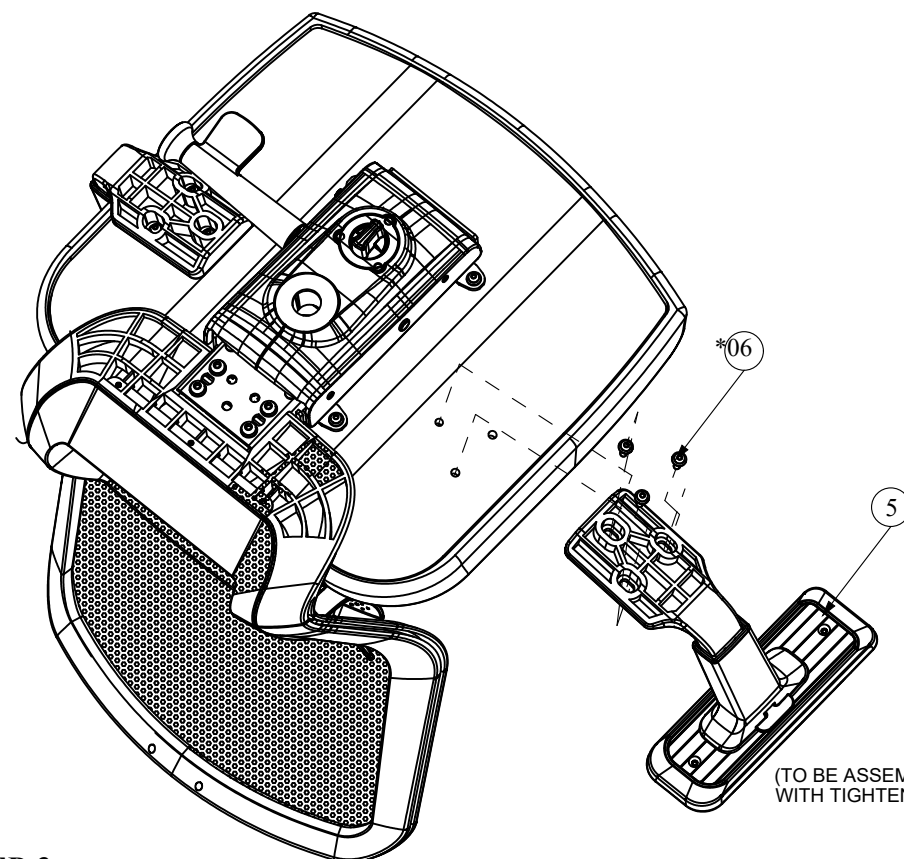

STEP-3
SCREW THE ARMREST TO THE SEAT.
(NOTE:- WHILE ASSEMBLING THE ARMREST, ALIGN IT SUCH THAT UNIFORM GAP IS MAINTAINED BETWEEN ARMREST AND BACK.)

(TO BE ASSEMBLED USING A TORQUE WRENCH WITH TIGHTENING TORQUE 6 N-m Max)

#PREFITTED WITH BACK
*PREFITTED WITH SEAT

Sr.No.	DESCRIPTION	QTY.
01	GRETA 2 UPH SEAT ASSEMBLY	1
02	BIO SYNCHRO MECHANISM	1
03	GREAT 2 UPH BACK ASSEMBLY	1
04	M8x30 INT. SOC BUTTON HD M/C SCREW	04
05	GRETA 2 ARMREST ASSEMBLY	1 pair
06	M6x30 INT. SOC BUTTON HD M/C SCREW	6
07	GAS LIFT ASSEMBLY T3	1
08	CASTOR REGAL SLEEK60 HUB Ø23.5 WITH KING PIN	5
09	PEDESTAL MODEL-JNB254 DIA 50.8	1
10	GRETA 2 HEADREST ASSEMBLY	01
11	M6x35 SOC BUTTON HD M/C SCREW	02
12	M6 HEX NUT	02
13	CAP FOR BACK FRAME	02
14	GRETA 2 HEADREST REAR CAP	01

* PLEASE STUDY THE ASSEMBLY INSTRUCTION CAREFULLY & FAMILIARISE YOURSELF WITH THE PARTS BEFORE ASSEMBLY.
* WORK AREA: TABLE TOP WITH CARTON LAID DOWN TO PROTECT THE SUB ASSEMBLY AND OTHER COMPONENTS
* ENSURE THAT ALL THE ITEMS LISTED IN PART LIST ARE PRESENT BEFORE ASSEMBLY
* AFTER ASSEMBLY CHECK THE GAP BETWEEN THE BACK AND ARMREST, IF UNEVEN UNSCREW THE BACK AND ARMREST AND ALIGN IT PROPERLY.

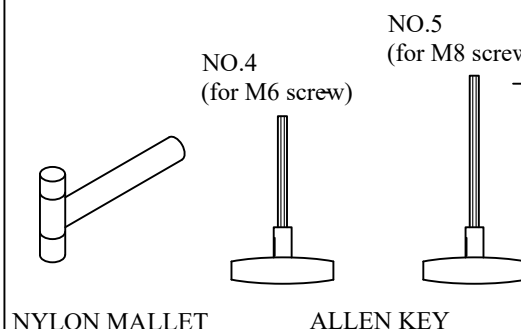
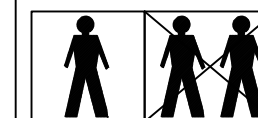

A6	ADDED A GENERAL NOTE	SUMIT	25/05/23	DEV.REV.
A5	ADDED NOTE ABOUT ARMREST.	SUMIT	09/02/23	DEV.REV.
A4	ADDED STEPS	SUMIT	06/12/22	DEV.REV.
A3	CHANGED THE HARDWARE FROM M6X25 TO M6X30	SUMIT	26/11/22	DEV.REV.
A2	ITEM No 4 & 11 updated for length	NITESH	28/10/22	DEV.REV.
A1	TABLE REARRANGED FOR NUMBERS.	NITESH	28/02/19	DEV.REV.
REV	MODIFICATION	MOD.BY	DATE	CH.NOTE NO

This Document is the copyrighted works of Godrej & Boyce Mfg. Co. Ltd. Godrej & Boyce Mfg. Co. Ltd. reserves all rights whatsoever in the document. Godrej & Boyce Mfg. Co. Ltd. asserts its rights over this document that has been conceived by the dint of its efforts and also views reproduction of this document, as it is or by making cosmetic or other changes, as a violation of its copyright. No part of this document shall be copied or reproduced without the written approval of Godrej & Boyce Mfg. Co. Ltd.

STEPS TO ASSEMBLE HEADREST

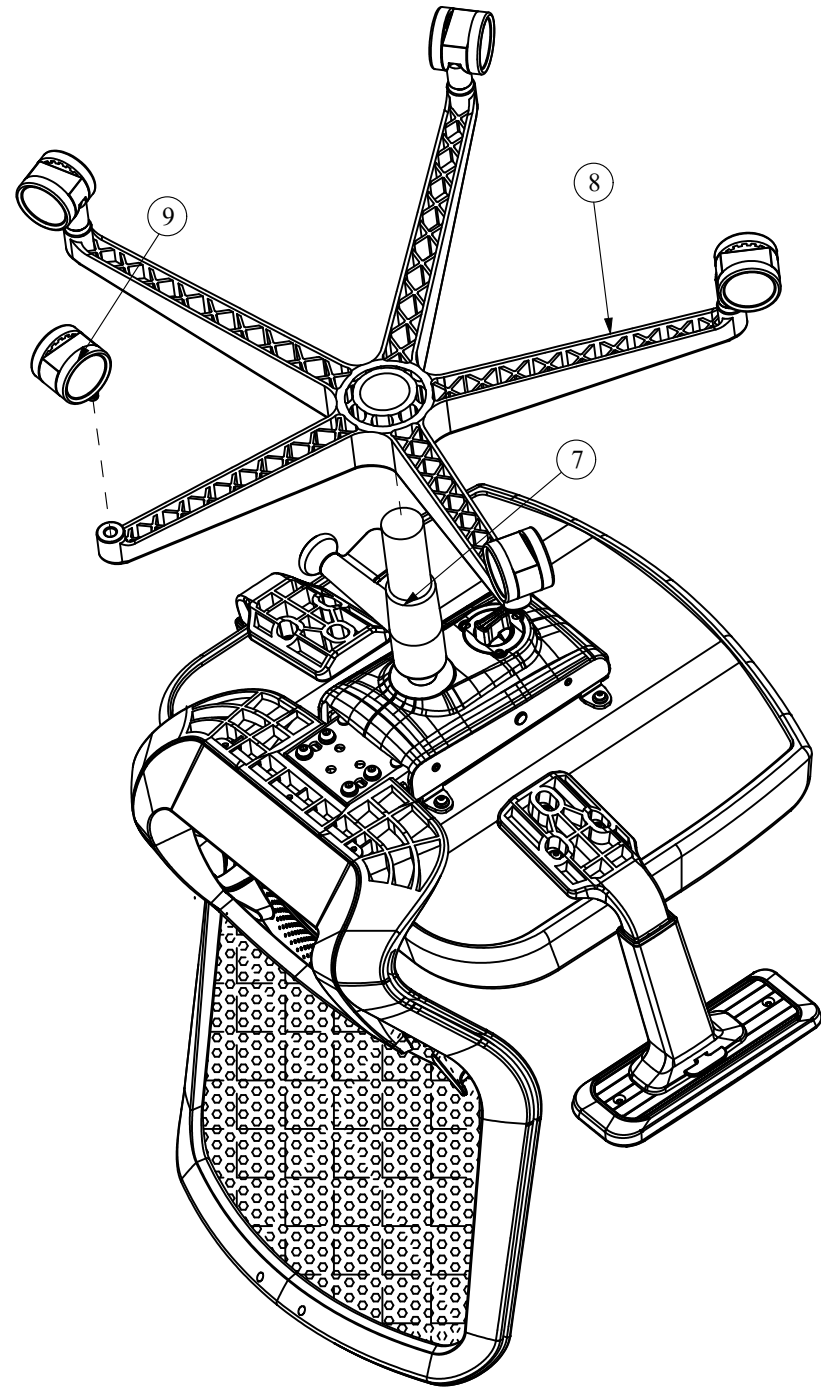

STEP-4:
FIT GASLIFT, PEDESTAL & CASTORS.

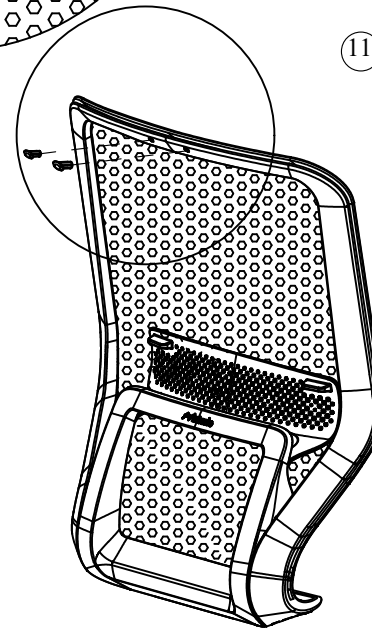
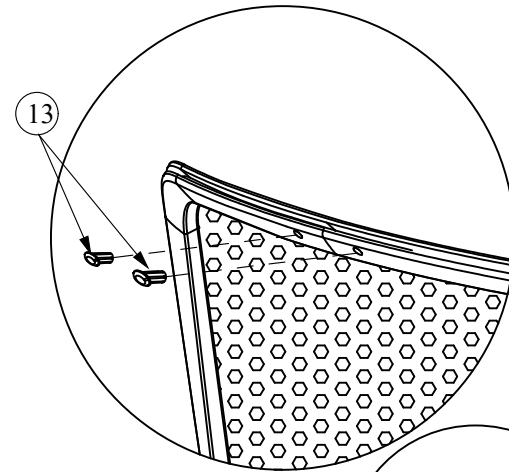

STEP A:
REMOVE THE PRESS FITTED
BACK FRAME CAP WITH THE
HELP OF SCREW DRIVER TO
ASSEMBLE THE HEADREST.

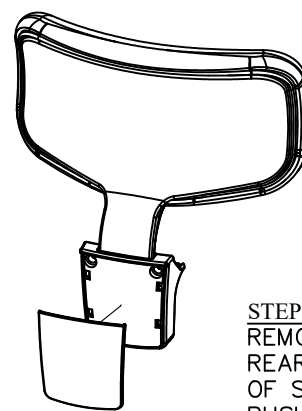

STEP B:
REMOVE THE SNAP FITTED
REAR CAP WITH THE HELP
OF SCREW DRIVER
PUSHING FROM DOWN.

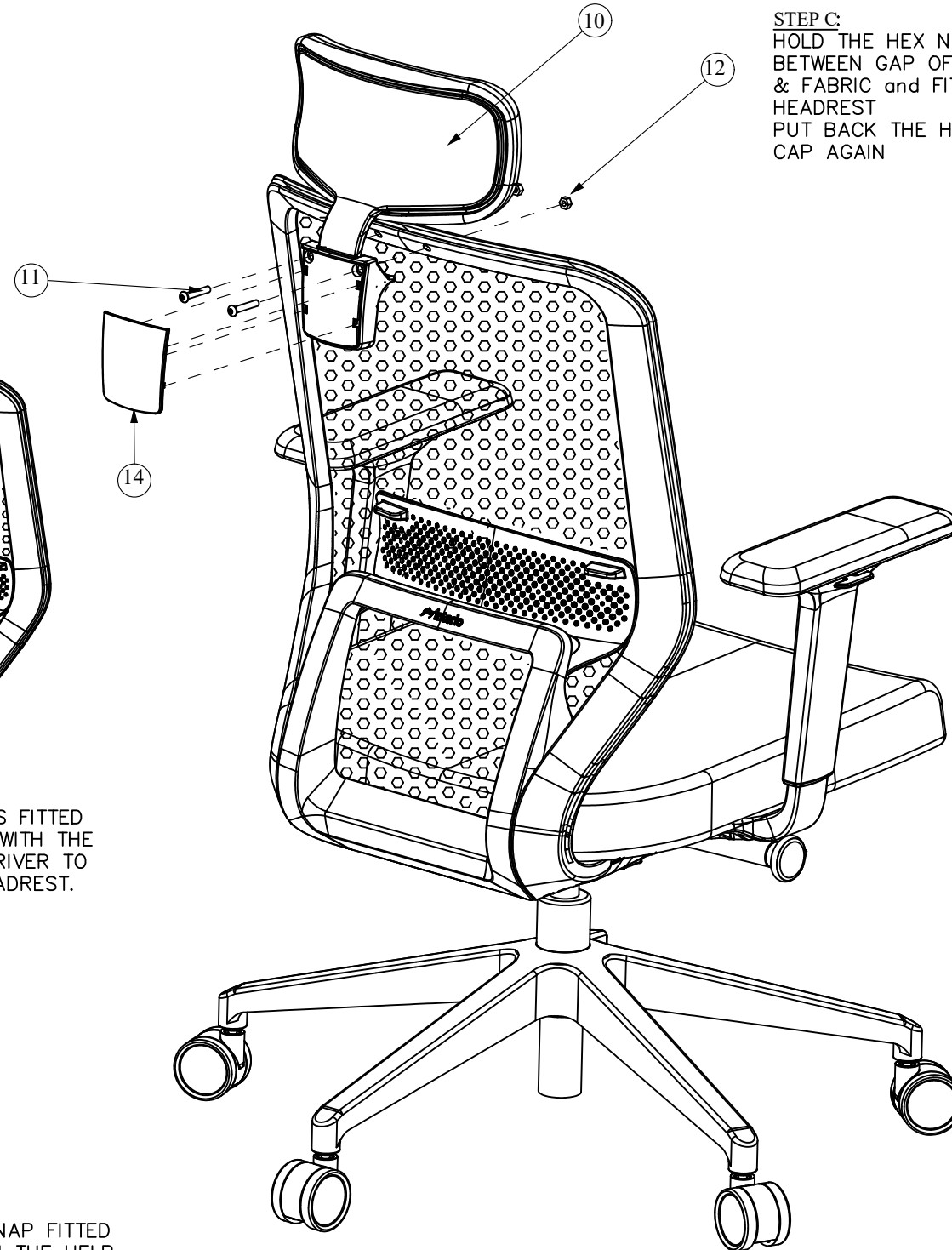

STEP C:
HOLD THE HEX NUT FROM INSIDE
BETWEEN GAP OF BACK FRAME
& FABRIC and FIT THE
HEADREST
PUT BACK THE HEADREST REAR
CAP AGAIN

REV	MODIFICATION	MOD. BY	DATE	CH.NOTE NO

This Document is the copyrighted works of Godrej & Boyce Mfg. Co. Ltd. Godrej & Boyce Mfg. Co. Ltd. reserves all rights whatsoever in the document. Godrej & Boyce Mfg. Co. Ltd. asserts its rights over this document that has been conceived by the dint of its efforts and also views reproduction of this document, as it is or by making cosmetic or other changes, as a violation of its copyright. No part of this document shall be copied or reproduced without the written approval of Godrej & Boyce Mfg. Co. Ltd.