

BR 088 095

PremiumLine body safety shower with pull rod diversion, above door installation, exposed pipework

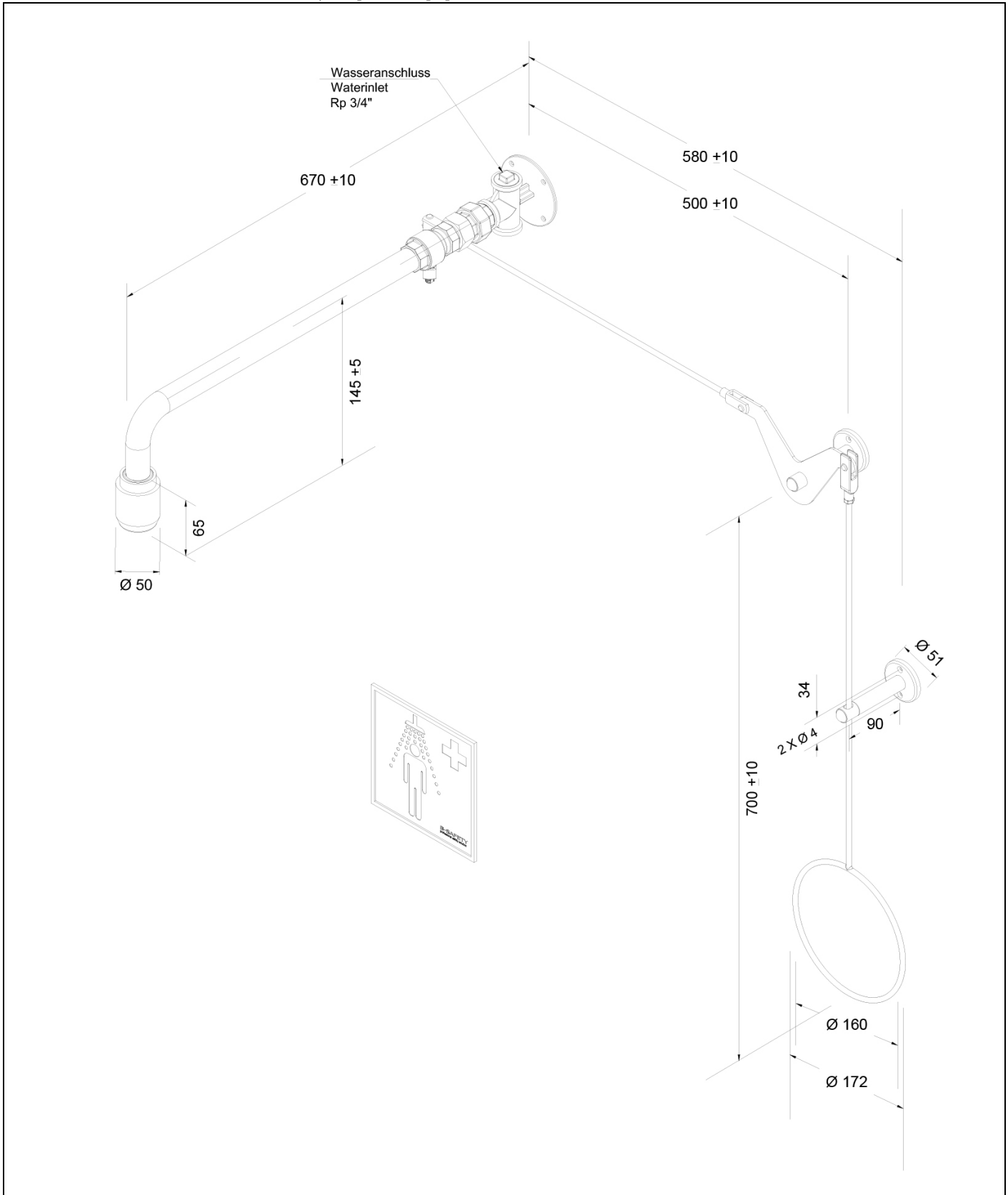

Technical description

PremiumLine body safety shower with pull rod diversion, above door installation, exposed pipework

- wall flange 3-fold of stainless steel with 2 connections for integration into a circulation pipe, mounting plate made of stainless steel with 4 mounting holes, polished, water inlet 3/4" female
- plug 3/4" with stainless steel
- screw connection 3/4" of stainless steel, conical sealing, for simplified installation on site
- ball valve of stainless steel, DIN-DVGW tested and certificated, with pull rod angle-diversion and wall bracket, can be mounted either on the right or left side of the door
- pull rod with ring handle of stainless steel, polished, length 700 mm
- holder for pull rod made of stainless steel, polished
- wall shower arm 3/4" of stainless steel, polished, projection 670 mm
- integrated automatic flow regulation 50 l/min. for a spray pattern acc. to the norms at a specified operating range of 1.5 to 3 bar dynamic water pressure
- high-performance shower head of stainless steel, polished, with improved spray pattern, corrosion resistant, largely calcification- and maintenance-free, very robust, self-draining
- sign for body safety shower according to EN ISO 7010 und ASR A1.3, self-adhesive PVC-film, 150 x 150 mm, viewing distance 15 metre
- mounting height 2345 mm (± 100 mm)
- according to BGI/GUV-I 850-0, DIN 1988 and EN 1717
- according to ANSI Z358.1-2014, EN 15154-1:2006 and EN 15154-5:2019
- DIN-DVGW tested and certificated

Manufacturer: B-SAFETY or equal
Article-No.: BR 088 095

Technical specifications

Minimum flow pressure:	1.5 bar
Operating pressure:	1.5 to 3 bar
Flow rate:	50 l/min
Water inlet:	3/4" female
Dimensions (H x W x D):	790 x 580 x 670 mm

Norm conformity

- EN 15154-1:2006
- EN 15154-5:2019
- ANSI Z358.1-2014

Approvals

- DIN-DVGW, DVGW, NW-0416CL0425

Material-overview

Material

Material description

High-performance shower head:	stainless steel	AISI 316
Ball valve:	stainless steel	AISI 316
Flow regulator:	plastic POM	-
Piping:	stainless steel	AISI 316
Pul rod with ring handle:	stainless steel	AISI 316
Wall flange, screw connection, plug:	stainless steel	AISI 316
Sign for body safety shower:	PVC-foil	-

www.b-safety.com

Product overview	
BR 088 095	PremiumLine body safety shower with pull rod diversion, above door installation, exposed pipework - flow rate 50 l/min (hazard class I according to EN 15154-5:2019)
BR 088 095 / 75L	PremiumLine body safety shower with pull rod diversion, above door installation, exposed pipework - flow rate 75 l/min / 20 GPM (hazard class II according to EN 15154-5:2019)
BR 088 095 / 110L	PremiumLine body safety shower with pull rod diversion, above door installation, exposed pipework - flow rate 110 l/min (hazard class III according to EN 15154-5:2019)

